



## 53c Granville Road Sevenoaks, Kent, TN13 1HB

Greenleaf are delighted to offer for rent this two bedroom top floor Apartment situated within a stones throw of Sevenoaks train station. The property layout consists of private entrance staircase and spacious landing, two double bedrooms, large kitchen/dining room, living room and bathroom. Benefits include gas central heating, Parking and Garage. Call now to arrange your internal viewing. Available from 09th Feb.

In order to reserve a property you will be required to pay a holding deposit equivalent to one weeks rent. This will be refunded once checks are complete unless false or misleading information is provided, a Right to Rent check fails or you withdraw from the property. It can, with agreement be put towards the first months rent due along with the five week deposit. If you require any further information just give the team a call or email on [info@greenleaf-property.co.uk](mailto:info@greenleaf-property.co.uk).

Greenleaf are a member of the PRS (property redress scheme) membership number:PRS003992  
Greenleaf Property Services Ltd have client money protection – property mark - membership – C0128543

**£1,700 PCM**

# 53c Granville Road

Sevenoaks, Kent, TN13 1HB



- TWO BEDROOMS
- WALKING DISTANCE TO RAILWAY STATION
- COUNCIL TAX BAND C
- GARAGE INCLUDED
- PARKING
- SPACIOUS
- 5 WEEK DEPOSIT £1961.53
- HOLDING FEE £392.30

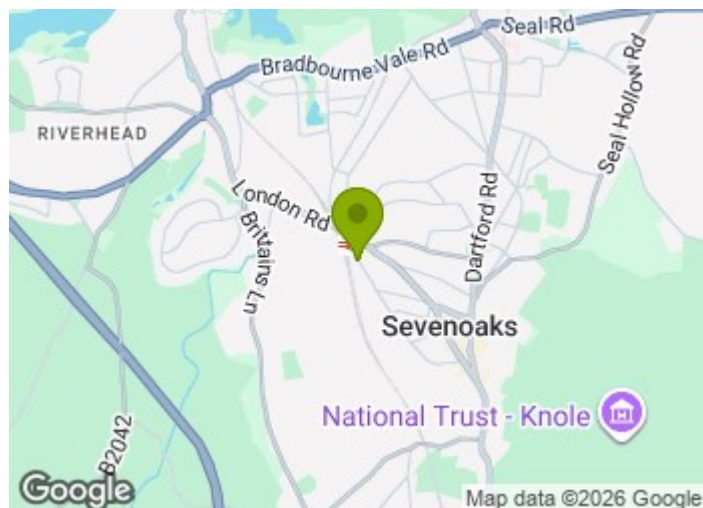

[Directions](#)

Tel: 01634730672





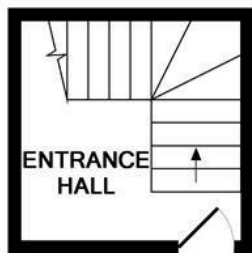

ENTRANCE FLOOR  
APPROX. FLOOR  
AREA 73 SQ.FT.  
(6.8 SQ.M.)

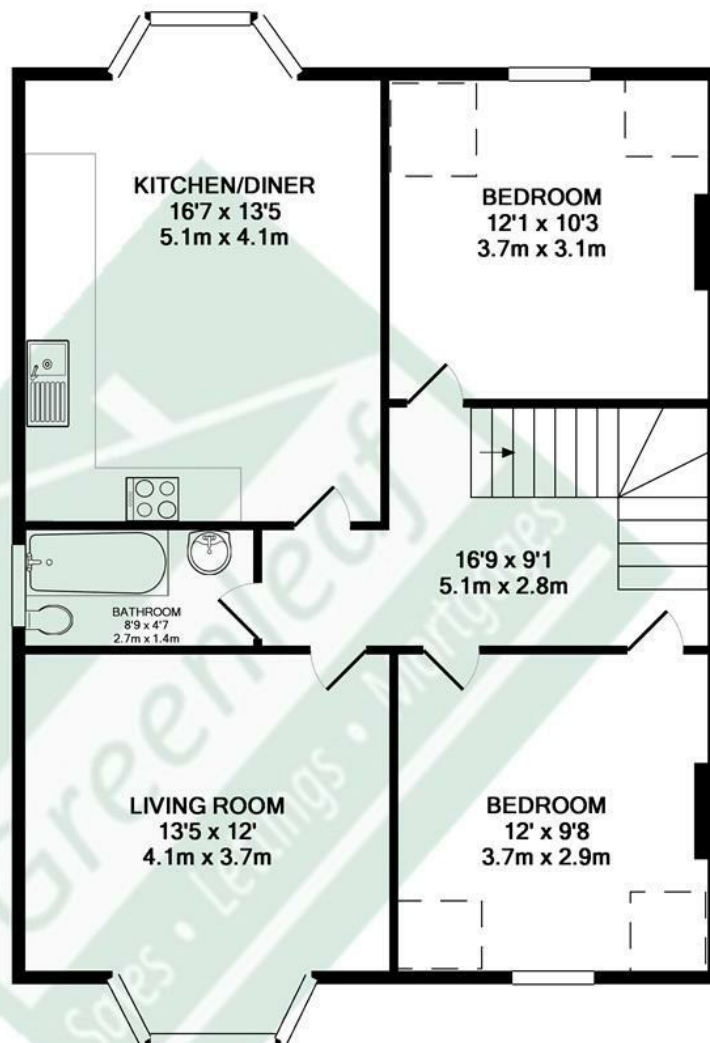

3RD FLOOR  
APPROX. FLOOR  
AREA 865 SQ.FT.  
(80.3 SQ.M.)

TOTAL APPROX. FLOOR AREA 937 SQ.FT. (87.1 SQ.M.)

Whilst every attempt has been made to ensure the accuracy of the floor plan contained here, measurements of doors, windows, rooms and any other items are approximate and no responsibility is taken for any error, omission, or mis-statement. This plan is for illustrative purposes only and should be used as such by any prospective purchaser. The services, systems and appliances shown have not been tested and no guarantee as to their operability or efficiency can be given  
Made with Metropix ©2013

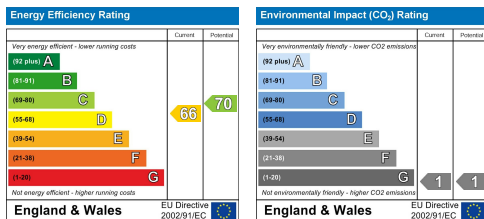

Greenleaf Property Services is a trading name of Greenleaf Property Services Limited.  
Registered Office: 281 Wilson Avenue, Rochester Kent ME1 2SS  
Registered No: 06222461 England. VAT No: 908929091

These particulars, whilst believed to be accurate are set out as a general outline only for guidance and do not constitute any part of an offer or contract. Intending purchasers should not rely on them as statements of representation of fact, but must satisfy themselves by inspection or otherwise as to their accuracy. No person in this firm's employment has the authority to make or give any representation or warranty in respect of the property.